

## 1. Setup Outlet to Auto Reset when Ping Fails

### Network Diagram

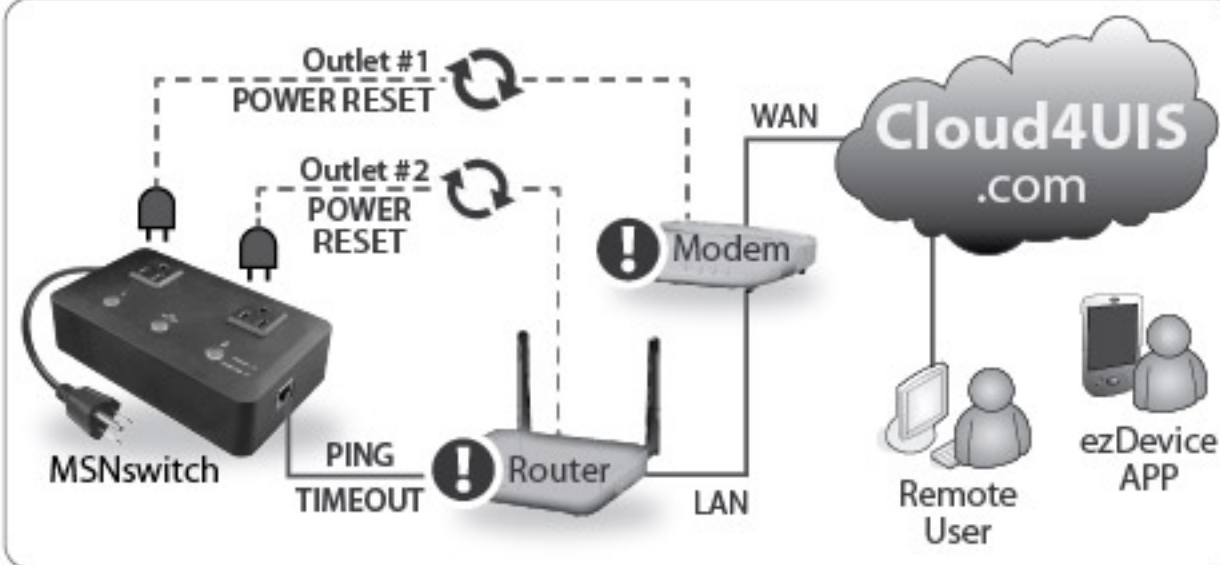

### Hardware Setup

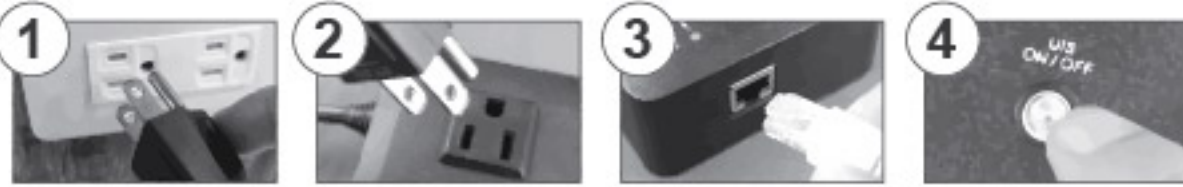

**Step 1:** Connect MSNswitch power plug to a wall outlet.

**Step 2:** Connect Modem to Outlet #1, and Router to Outlet #2.

**Step 3:** Connect LAN cable from Router to MSNswitch. The Internet LED will turn ON to indicate online.

**Step 4:** Press and hold UIS ON / OFF button (2 seconds) to enable Auto Reset function.

## 2. Description



## 3. LED Indicators

LED	ON	OFF	BLINKING
Internet	Online	Offline	≥1 IP has timeout
Cloud Link	Device linked & is connected to server	Device not linked to a Cloud account	Device not linked & is connected to server
UIS ON / OFF	Enabled (Auto Reset)	Disabled (Manual Control)	- n/a -

LED (Status)	Description
#1, UIS & #2 (Blinking)	Reset to Factory Default
All LEDs (Blinking)	Firmware Upgrading. DO NOT interrupt or power off !

## 4. [Add] Device to APP & Cloud4UIS

**Step 1:** Install ezDevice APP, and [Sign Up] for a Cloud4UIS Account.



**Step 2:** Add Device to Cloud4UIS Account

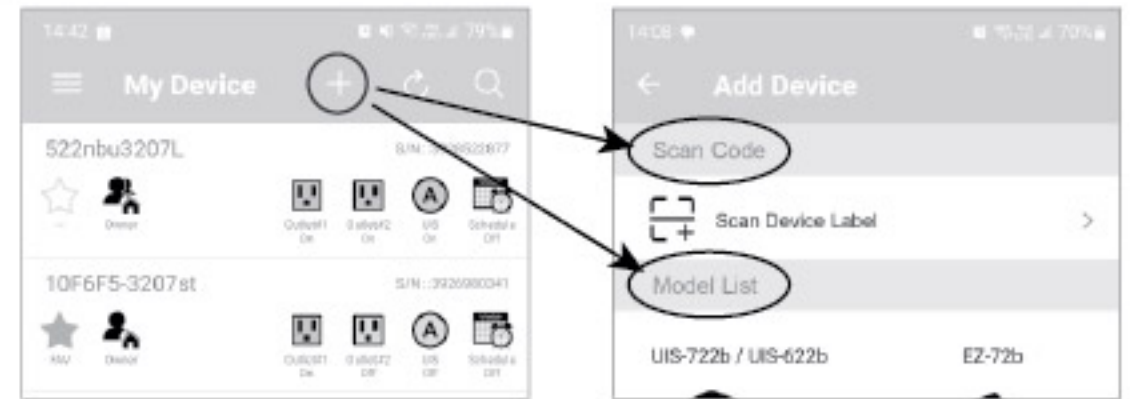

### NOTE:

- Once the device is 'Added', the Cloud Link LED will change from BLINKING to ON.
- The first person to 'Add' the device becomes the 'Owner'.
- Each device can only have one 'Owner'.
- 'Owner' can 'Share' device with other Cloud4UIS user and set these user's access permission.

## 5. Access Device Web User Interface (GUI)

Access to all MSNswitch functionality is available via it's web user interface. Enter MSNswitch IP address into any browser.

**http://<IP-address-of-Device>** eg.: **http://192.168.0.123**

### NOTE:

- Check router DHCP table for IP address.
- For first time login (or after a factory default) user must create an administrator account and password.

## 6. Setup Instant Messaging (Skype)

**Step 1:** Login to **http://<IP-address-of-Device>**

**Step 2:** Goto **Configuration --> Skype --> [Enable]** and click the "Auto Rebooter" link.

**Step 3:** Add "Auto Rebooter" robot to your Skype contacts and begin a messaging session.

**Step 4:** Type **Help --> [Get My ID]** to generate a unique ID. Copy and paste to **[My ID]** in MSNswitch. Click **[Add]** to save.

**NOTE:** Skype is owned by Microsoft. Use of Skype is subject to Microsoft usage terms and conditions.

## 7. [Remove] Device from APP & Cloud4UIS

**Method 1:** From either APP or Cloud4UIS Account. Select **[Remove Device]**.

**NOTE:** This action removes device from APP or Cloud. The individual configuration is still retained on device.

**Method 2:** From Device: Reset to Factory Default.

Press & Hold Outlet #1 & #2 for 10 seconds. Release when all three LED start blinking.

**NOTE:** This action clears device configuration and removes device link to APP / Cloud4UIS Account.

rev. 3b21

For the latest firmware, please visit <http://www.MSNswitch.com>



For model: UIS-722b

**Quick Installation Guide**



Scan QR Code for Guide